

### ZQ35 拖链-安装尺寸及技术参数

### ZQ35 Cable Chain-Installation Dimensions and Technical Parameters

#### 架空长度

#### Unsupported length

- $L_G$  = 直线架空长度
- $L_A$  = 安全塌腰架空长度
- $L_G$  = Unsupported with straight upper run
- $L_A$  = Unsupported with permitted sag

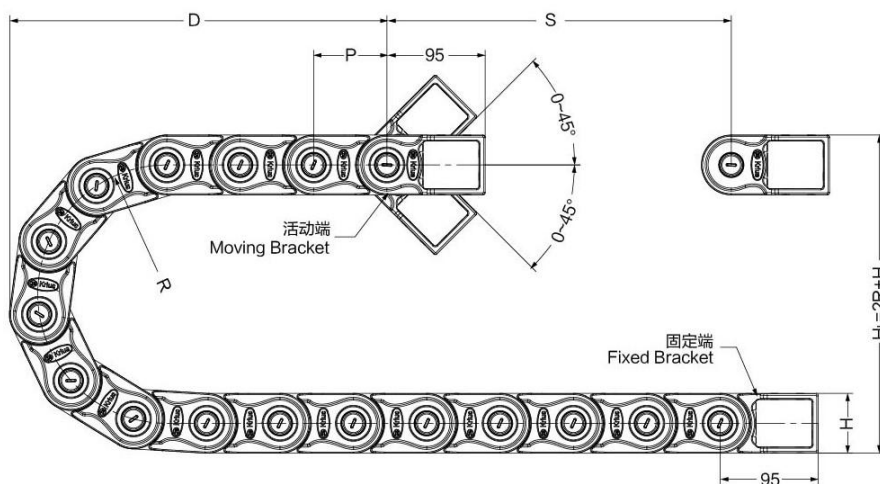
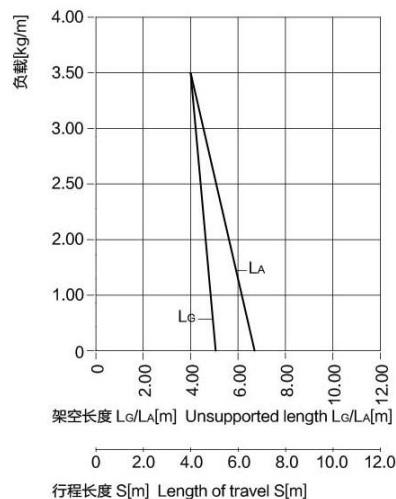
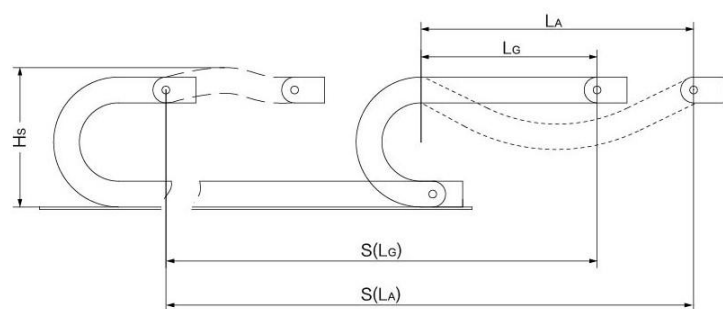

- S = 行程长度
- R = 弯曲半径
- P = 节距
- L = 拖链长度
- N = 每米链节数
- H<sub>L</sub> = 理论安装高度
- H<sub>s</sub> = 实际安装高度
- D = 拖链退回极限位置时的最小距离
- $K = \pi \cdot R + 2P$
- \* K值可在科瑞斯相关表格中直接查询
- S = Length of travel
- R = Bending Radius
- P = Pitch
- L = Length of chain
- N = Links per meter
- H<sub>L</sub> = Nominal clearance height
- H<sub>s</sub> = Required clearance height
- D = Overlength Energy Chain radius in final position
- $K = \pi \cdot R + 2P$
- \* You can find it from below chart for more details

| R           | H <sub>L</sub> | D           | K            | P         |
|-------------|----------------|-------------|--------------|-----------|
| 75 (2.95)   | 208 (8.19)     | 160 (6.30)  | 380 (14.96)  | 71 (2.80) |
| 100 (3.94)  | 258 (10.16)    | 210 (8.27)  | 455 (17.91)  | 71 (2.80) |
| 125 (4.92)  | 308 (12.13)    | 260 (10.24) | 535 (21.06)  | 71 (2.80) |
| 150 (5.91)  | 358 (14.09)    | 310 (12.20) | 615 (24.21)  | 71 (2.80) |
| 175 (6.89)  | 408 (16.06)    | 360 (14.17) | 690 (27.17)  | 71 (2.80) |
| 200 (7.87)  | 458 (18.03)    | 410 (16.14) | 770 (30.31)  | 71 (2.80) |
| 250 (9.84)  | 558 (21.97)    | 510 (20.08) | 925 (36.42)  | 71 (2.80) |
| 300 (11.81) | 658 (25.91)    | 610 (24.02) | 1085 (42.72) | 71 (2.80) |

实际安装高度:  $H_s = H_L + 50\text{mm}$   
 拖链长度:  $L = S/2 + K$   
 每米链节数:  $N = 14$  (994mm)

The required clearance height:  $H_s = H_L + 1.97\text{in.}$   
 Chain length:  $L = S/2 + K$   
 Links per meter:  $N = 14$  (39.13 in.)

| 技术参数 Technical Parameters |                                |  |
|---------------------------|--------------------------------|--|
| 速度/加速度 $L_G$              | Speed/acceleration $L_G$       | max.25[m/s]/max.205[m/s <sup>2</sup> ] |
| 速度/加速度 $L_A$              | Speed/acceleration $L_A$       | max.5[m/s]/max.8[m/s <sup>2</sup> ]    |
| 滑行速度/加速度                  | Gliding speed/acceleration     | max.5[m/s]/max.12[m/s <sup>2</sup> ]   |
| 材料-允许温度 °C                | Material-permitted temperature | igumid G/-40°C至+125°C                  |
| 阻燃等级, igumid G            | Flammability Class, igumid G   | VDE 0304 IIC UL94 V2                   |

## ZQ35 拖链-产品规格范围 ZQ35 Cable Chain-Product specifications

ZQ35拖链-内外侧可开 ZQ35 Cable Chain-Inner and outer can be opened

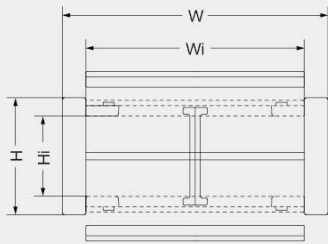

产品代码结构  
Part Number Structure

ZQ3575\*R\*L\*n

- 数量 (Quantity)
- 拖链长度 (Length of Cable chains)
- 弯曲半径 (Bending Radius)
- 内宽 (Inner Width)
- 型号 (Type)

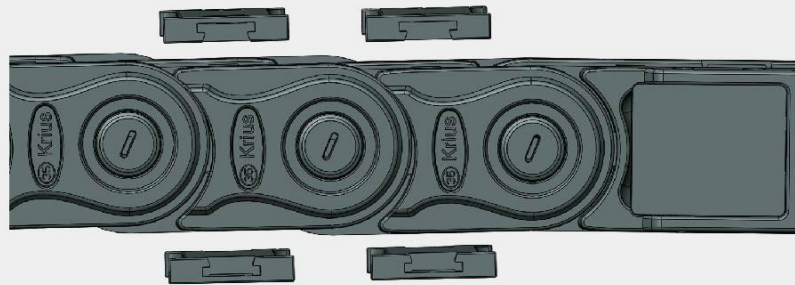

| 型号<br>Type | 弯曲半径<R><br>Bending radius<br>mm (in.) | 内高<Hi><br>Inner height<br>mm (in.) | 内宽<Wi><br>Inner width<br>mm (in.) | 外高<H><br>Outer height<br>mm (in.) | 外宽<W><br>Outer Width<br>mm (in.) | 重量<G><br>Weight<br>kg/m (lbs/ft) | 备注<br>Remark |
|------------|---------------------------------------|------------------------------------|-----------------------------------|-----------------------------------|----------------------------------|----------------------------------|--------------|
| ZQ3575     |                                       | 35 (1.38)                          | 76 (2.99)                         | 58 (2.28)                         | 102 (4.02)                       | 2.04 (1.39)                      |              |
| ZQ35100    |                                       |                                    | 101 (3.98)                        |                                   | 127 (5.00)                       | 2.18 (1.48)                      |              |
| ZQ35125    |                                       |                                    | 126 (4.96)                        |                                   | 152 (5.98)                       | 2.33 (1.58)                      |              |
| ZQ35150    |                                       |                                    | 151 (5.94)                        |                                   | 177 (6.97)                       | 2.49 (1.69)                      |              |
| ZQ35200    |                                       |                                    | 201 (7.91)                        |                                   | 227 (8.94)                       | 2.77 (1.88)                      |              |
| ZQ35250    |                                       |                                    | 251 (9.88)                        |                                   | 277 (10.91)                      | 3.05 (2.07)                      |              |
| ZQ35300    |                                       |                                    | 301 (11.85)                       |                                   | 327 (12.87)                      | 3.33 (2.26)                      |              |
| ZQ35350    |                                       |                                    | 351 (13.82)                       |                                   | 377 (14.84)                      | 3.64 (2.48)                      |              |
| ZQ35400    |                                       |                                    | 401 (15.79)                       |                                   | 427 (16.81)                      | 3.92 (2.67)                      |              |

订货范例  
Order details

ZQ3575 \* R100 \* 1000mm \* 2

| R           | HL          | D           | K            | P         |
|-------------|-------------|-------------|--------------|-----------|
| 75 (2.95)   | 208 (8.19)  | 160 (6.30)  | 380 (14.96)  | 71 (2.80) |
| 100 (3.94)  | 258 (10.16) | 210 (8.27)  | 455 (17.91)  | 71 (2.80) |
| 125 (4.92)  | 308 (12.13) | 260 (10.24) | 535 (21.06)  | 71 (2.80) |
| 150 (5.91)  | 358 (14.09) | 310 (12.20) | 615 (24.21)  | 71 (2.80) |
| 175 (6.89)  | 408 (16.06) | 360 (14.17) | 690 (27.17)  | 71 (2.80) |
| 200 (7.87)  | 458 (18.03) | 410 (16.14) | 770 (30.31)  | 71 (2.80) |
| 250 (9.84)  | 558 (21.97) | 510 (20.08) | 925 (36.42)  | 71 (2.80) |
| 300 (11.81) | 658 (25.91) | 610 (24.02) | 1085 (42.72) | 71 (2.80) |

## ZQ35 拖链-拖链接头 ZQ35 Cable Chain-Mounting Bracket

塑料接头或钢制接头,分体式 Plastic or Steel Mounting Bracket, Splitted structure

- 双侧独立式塑料接头或钢制接头
- 两端接头均可活动
- 耐腐蚀 & 耐摩擦
- 可提供预装配形式
- 可实现内外连接
- Independent Plastic or Steel mounting bracket on the two end
- Moved connectors on both sides
- Anti-corrosion, Rub-resistance
- Available preassembly form
- Can realize the internal and external connections

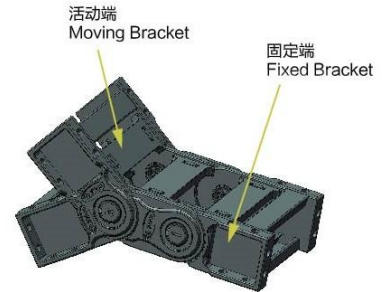

可选配的接头安装方式 Available installation methods

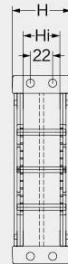
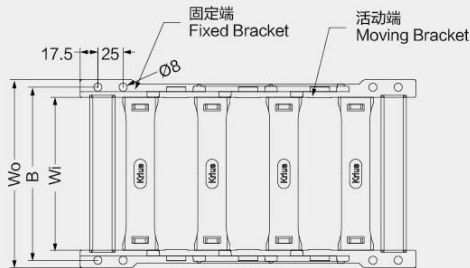
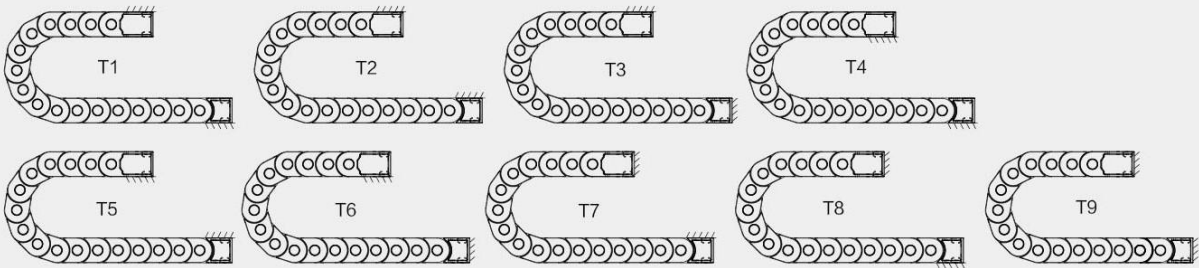

ZQ3575 / ZQ35100 / ZQ35125 / ZQ35150 / ZQ35200  
ZQ35250 / ZQ35300 / ZQ35350 / ZQ35400

| 拖链型号<br>Type | 拖链编码<br>Code | 其他编码<br>Other Code     | Wo尺寸<br>Dimension Wo | B尺寸<br>Dimension B |
|--------------|--------------|------------------------|----------------------|--------------------|
|              |              |                        | mm (in.)             | mm (in.)           |
| ZQ3575       | 11226        |                        | 111 (4.37)           | 96 (3.78)          |
| ZQ35100      | 11227        |                        | 136 (5.35)           | 121 (4.76)         |
| ZQ35125      | 14082        | 接头<br>Mounting Bracket | 161 (6.34)           | 146 (5.75)         |
| ZQ35150      | 11228        | 12109                  | 186 (7.32)           | 171 (6.73)         |
| ZQ35200      | 11229        | 主体<br>Main Body Code   | 236 (9.29)           | 221 (8.70)         |
| ZQ35250      | 11230        | 12108                  | 286 (11.26)          | 271 (10.67)        |
| ZQ35300      | 11231        | 隔离片<br>Separator       | 336 (13.23)          | 321 (12.64)        |
| ZQ35350      | 11232        | 12113                  | 386 (15.20)          | 371 (14.61)        |
| ZQ35400      | 11233        |                        | 436 (17.17)          | 421 (16.57)        |

产品代码结构 Part Number Structure

### ZQ3575\*B\*T1



- ZQ3575\*B\*T1\*n 两端接头  
On both brackets
- ZQ3575\*f\*T1\*n 固定端接头  
Fixed bracket
- ZQ3575\*m\*T1\*n 移动端接头  
Moving bracket

★ 每款拖链的接头都有所不同, 订购时如有任何疑问, 请及时咨询科瑞斯。  
Every bracket is different, please contact us if you have any question.



ZQ35 拖链  
ZQ35 Cable Chain

## ZQ35 拖链-隔离片 ZQ35 Cable Chain-Separator

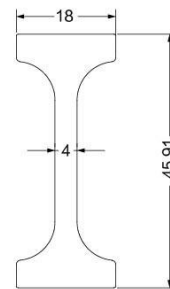
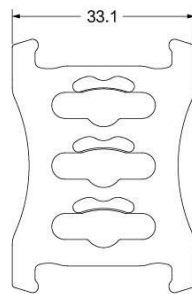

ZQ35拖链隔离片编码：12113  
The separator No. for ZQ35: 12113

- 本款拖链标配隔离片为竖隔片，可以实现垂直分隔，也可订制铝杆作为横隔片，实现水平分隔
- 竖隔片的数量可以根据客户的实际需求进行配备，可以每隔一个链节装一个，也可以每隔一个链节装几个，客户可任意配备
- 竖隔片安装完成后，可以根据线缆排布进行滑动
- The standard separator is vertical direction which can make the vertical division, and also we can customize horizontal Al separator for horizontal division
- Vertical separators can be placed into each link or different quantity links, it can be customized
- Vertical separator can be moved for different cables